

SKIDDER UNIT

The Skidder Unit is a rugged device designed to move massive loads on skidways. It is comprised of proven matched components: No. 4 AC Motor with pinion driving a No. 4 Gearbox and a secondary reduction geared output pinion. More than 200 Skidder Units have been installed to move the giant substructures with derrick, draw-works, rotary and related equipment on mobile offshore drilling platforms. Each final drive pinion delivers an enormous 263,000 lbs. of thrust at 6.57 F.P.M.

*"A Product
with Experience"*



*263,000 lbs.
Thrust*

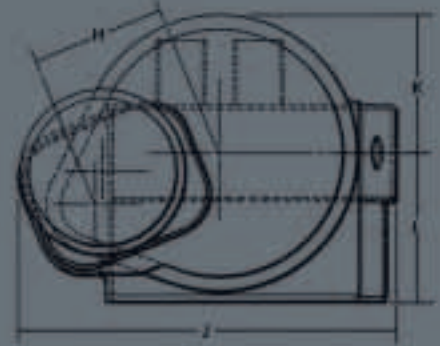
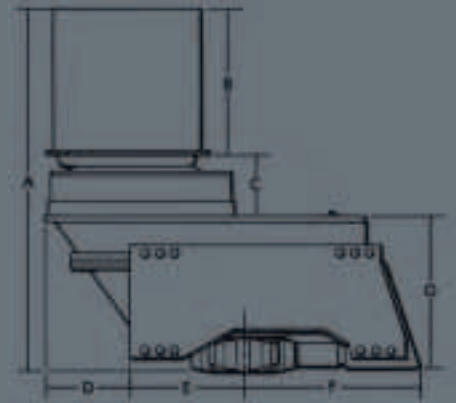

A - 60" 1524 mm B - 24-1/4" 616 mm

C - 10-1/4" 260 mm D - 14-1/4" 362 mm

E - 19" 482 mm F - 29" 736 mm

G - 25-1/2" 648 mm H - 22-1/2" 571 mm

J - 62-1/4" 1581 mm K - 23-1/4" 590 mm

L - 24-3/4" 629 mm

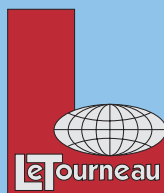

**LeTourneau, Inc.
Marine Group**

SPECIFICATIONS

	U.S.	Metric
Thrust Capacity	263,000 lbs.	119,300 kg
Travel @3/4 Motor Speed	6.57 F.P.M	2.00 m.P.M.
Holding Capacity	245,000 lbs.	111,130 kg

Gearing Information

376.36 Overall Gear Ratio
7 Tooth 1/2 Pitch Output Pinion
38 Tooth 1 Pitch Reduction Gear

Dimensions

Height (Overall)	60"	1524 mm
Width (Overall)	48"	1219 mm
Length (Overall)	62-1/4"	1581 mm
Weight	5,200 lbs.	2359 kg

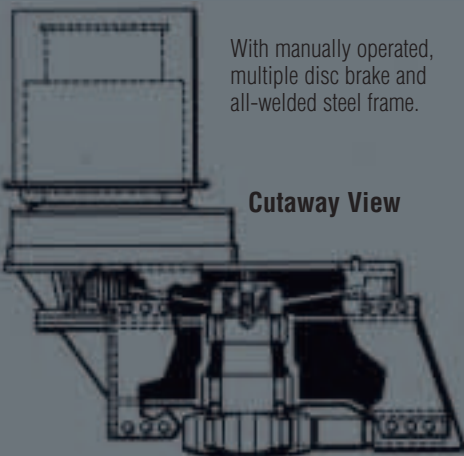

With manually operated, multiple disc brake and all-welded steel frame.

Cutaway View



View showing the massive substructure with drilling machinery moved into drilling position by the Skidder Unit.

No. 4 AC Motor

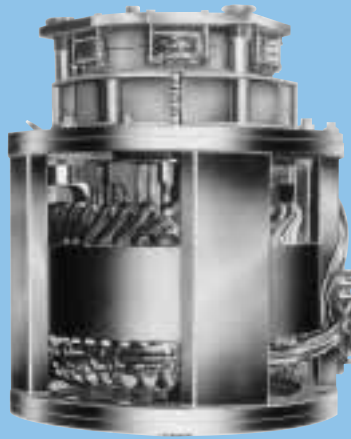

— Approximate Weight —
940 lbs. / 426 kg

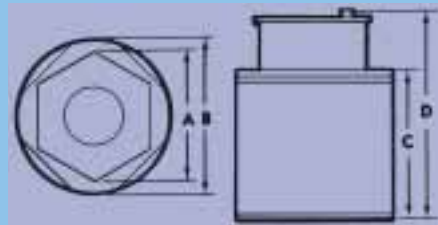

A - 16-3/4" 425 mm B - 21-3/4" 552 mm C - 16-3/4" 425 mm D - 24-1/4" 616 mm

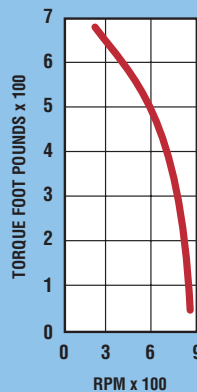

Motor should be torque rated at 3/4 speed

3 Phase Squirrel Cage Induction Motor

R.P.M.	900
Volts	440 AC
Cycles	60
Drive Pinion	8 Tooth - 6 Pitch
Electro-Magnetic Multiple Disc Brake	10 Face - 3 Segment

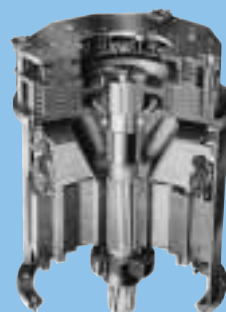

Cutaway View

No. 4 Gearbox

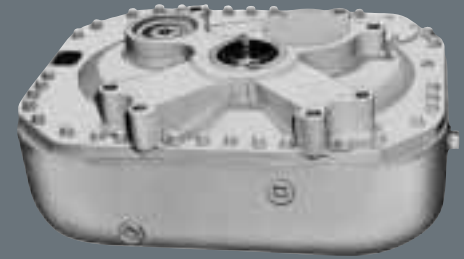

— Approximate Weight —
800 lbs. / 362.4 kg

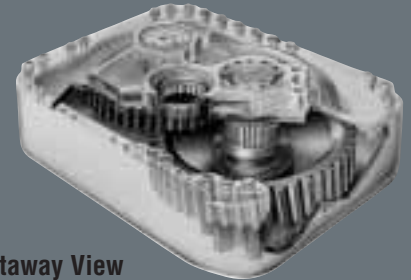

Cutaway View

Gearing Information

69.33 Overall Gear Ratio
7 Tooth 1 Pitch Output Pinion

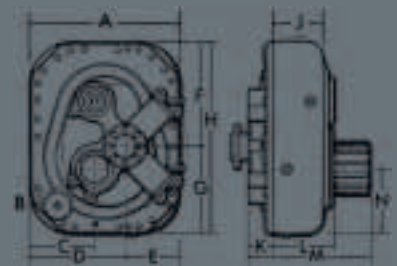

A - 22" 559 mm B - 18-1/2" 480 mm C - 9-1/2" 241 mm D - 14" 356 mm

E - 8" 203 mm F - 15-1/4" 387 mm G - 12-3/4" 324 mm H - 28" 711 mm

J - 7-1/4" 184 mm K - 3-1/2" 89 mm L - 9" 228 mm M - 18" 457 mm

N - 9-1/2" 241 mm

LeTourneau has made every effort to make these specifications as accurate as possible at the time of printing. However, we reserve the right to make changes and improvements at any time without notice in equipment, materials and specifications. To ensure the most current information, please contact your LeTourneau Marine representative.



LeTourneau, Inc.
Marine Group

P.O. Box 2307
2400 South McArthur Street
Longview, Texas 75602
Telephone: (903) 237-7500
FAX (903) 237-7569

5/05-2.5M
Printed in U.S.A.